

Surface Mount Schottky Rectifier

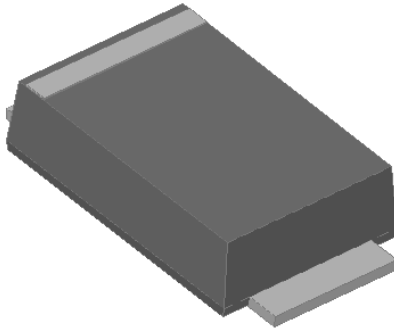

Features

- Low profile package
- Ideal for automated placement
- Guardring for overvoltage protection
- Low VF
- Low power losses, high efficiency
- High forward surge capability
- Meets MSL level 1, per J-STD-020, LF maximum peak of 260 °C

Typical Applications

For use in low voltage high frequency inverters, Freewheeling, DC/DC converters, and polarity protection Applications.

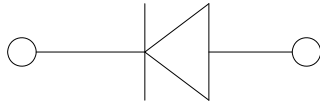

Mechanical Data

- **Package:** SMAF
Molding compound meets UL 94 V-0 flammability rating, RoHS-compliant, halogen-free
- **Terminals:** Tin plated leads, solderable per J-STD-002 and JESD22-B102
- **Polarity:** Cathode line denotes the cathode end

■ Maximum Ratings ($T_a=25^\circ\text{C}$ Unless otherwise specified)

PARAMETER	SYMBOL	UNIT	SL34F	SL345F	SL35F	SL36F	SL310F
Device marking code			SL34F	SL345F	SL35F	SL36F	SL310F
Repetitive peak reverse voltage	VRRM	V	40	45	50	60	100
Average rectified output current @60Hz sine wave, Resistance load, T_a (FIG.1)	IO	A	3.0				
Surge(non-repetitive)forward current @60Hz Half-sine wave, 1 cycle, $T_j=25^\circ\text{C}$	IFSM	A	60				
Storage temperature	Tstg	°C	-55 ~+150				
Junction temperature	Tj	°C	-55 ~+150				

■ Electrical Characteristics ($T_a=25^\circ\text{C}$ Unless otherwise specified)

PARAMETER	SYMBOL	UNIT	TEST CONDITIONS	SL34F	SL345F	SL35F	SL36F	SL310F
Maximum instantaneous forward voltage drop per diode	VF	V	IFM=3.0A	0.45		0.50		0.60
Maximum DC reverse current at rated DC blocking voltage per diode @VRM=VRRM	IR	mA	$T_a=25^\circ\text{C}$	0.5				0.1
			$T_a=100^\circ\text{C}$	10				5



SL34F THRU SL310F

■ Thermal Characteristics ($T_a=25^\circ\text{C}$ Unless otherwise specified)

PARAMETER	SYMBOL	UNIT	SL34F	SL345F	SL35F	SL36F	SL310F	
Thermal Resistance	R θ J-A	$^\circ\text{C}/\text{W}$	65 ⁽¹⁾					
	R θ J-L		20 ⁽¹⁾					

Note:
 (1) Thermal resistance from junction to ambient and from junction to lead mounted on P.C.B. with 0.2" x 0.2" (5.0 mm x 5.0 mm) copper pad areas

■ Characteristics (Typical)

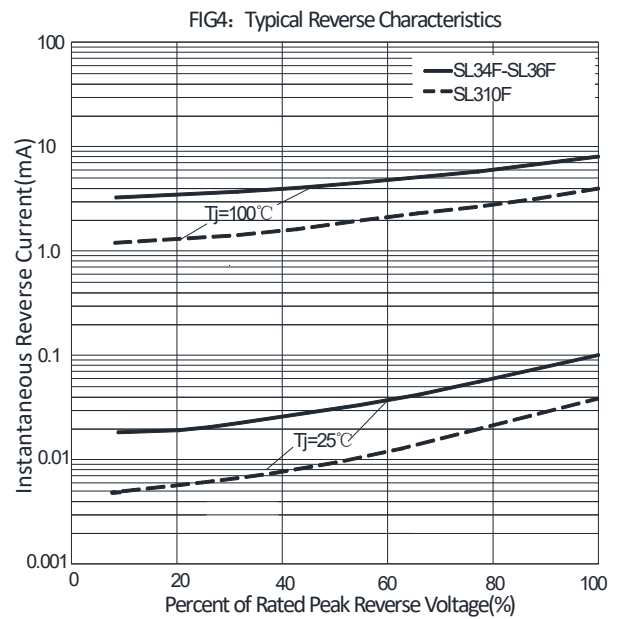
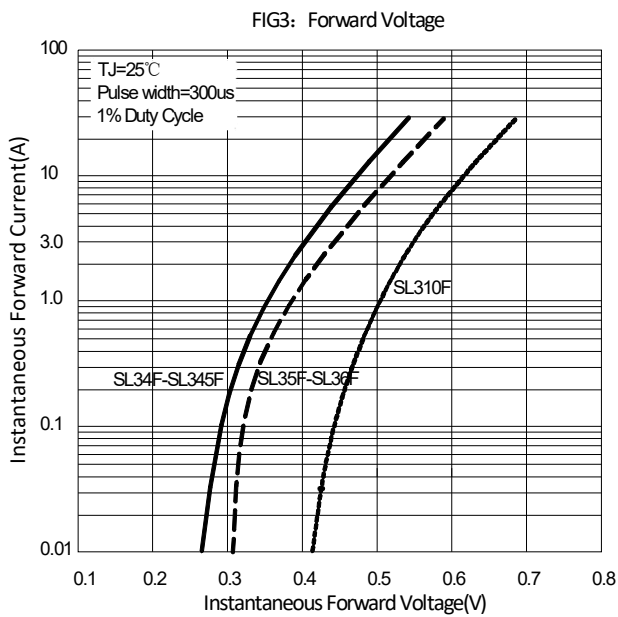
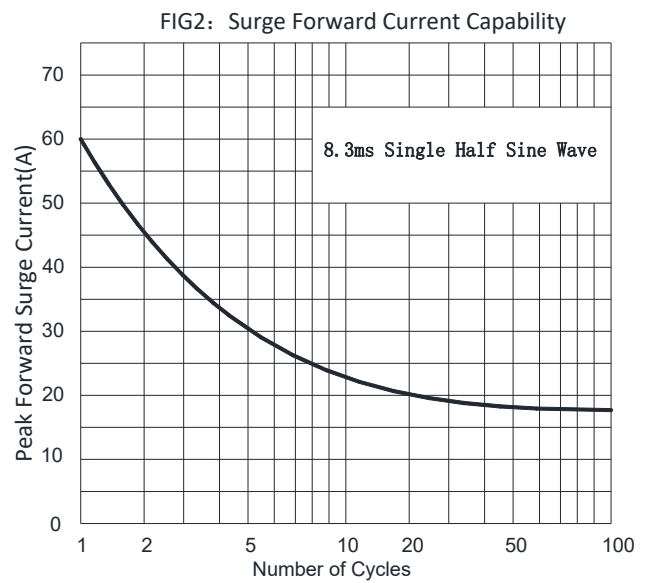
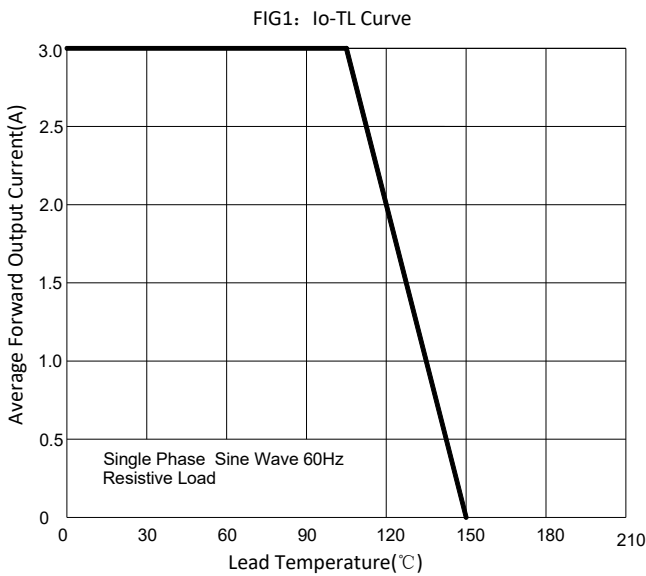



SL34F THRU SL310F

■ Ordering Information (Example)

PREFERRED P/N	PACKING CODE	UNIT WEIGHT(g)	MINIMUM PACKAGE(pcs)	INNER BOX QUANTITY(pcs)	OUTER CARTON QUANTITY(pcs)	DELIVERY MODE
SL34F-SL310F	F1	Approximate 0.034	3000	24000	96000	7" reel
SL34F-SL310F	F2	Approximate 0.034	10000	20000	160000	13" reel
SL34F-SL310F	F3	Approximate 0.034	10000	20000	120000	13" reel
SL34F-SL310F	F4	Approximate 0.034	7500	15000	120000	13" reel

■ Outline Dimensions

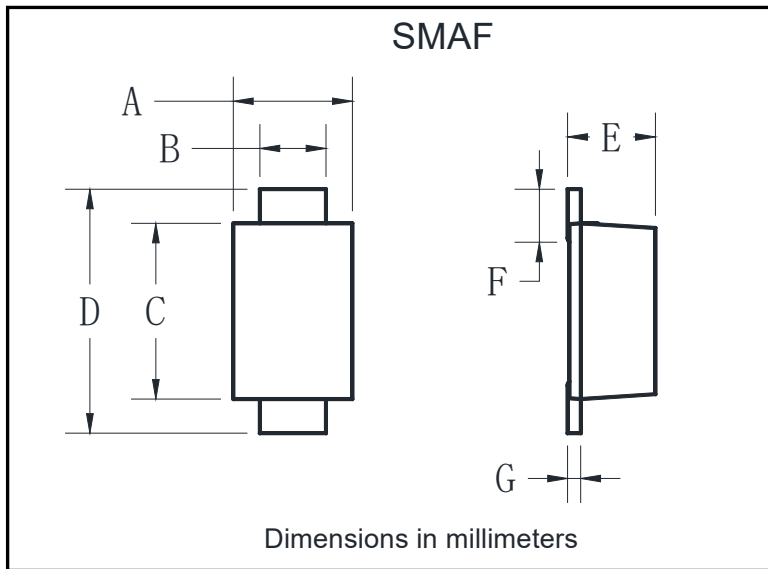

SMAF		
Dim	Min	Max
A	2.40	2.80
B	1.35	1.45
C	3.40	3.60
D	4.40	4.80
E	1.05	1.25
F	0.50	1.00
G	0.15	0.22

■ Suggested pad layout

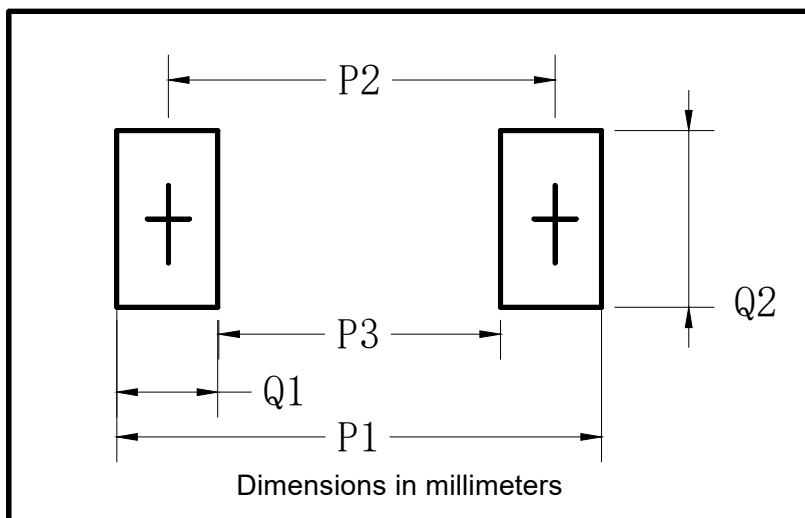

SMAF	
Dim	Millimeters
P1	6.50
P2	4.00
P3	1.50
Q1	2.50
Q2	1.70



SL34F THRU SL310F

Disclaimer

The information presented in this document is for reference only. Yangzhou Yangjie Electronic Technology Co., Ltd. reserves the right to make changes without notice for the specification of the products displayed herein to improve reliability, function or design or otherwise.

The product listed herein is designed to be used with ordinary electronic equipment or devices, and not designed to be used with equipment or devices which require high level of reliability and the malfunction of which would directly endanger human life (such as medical instruments, transportation equipment, aerospace machinery, nuclear-reactor controllers, fuel controllers and other safety devices), Yangjie or anyone on its behalf, assumes no responsibility or liability for any damages resulting from such improper use of sale.

This publication supersedes & replaces all information previously supplied. For additional information, please visit our website [http:// www.21yangjie.com](http://www.21yangjie.com) , or consult your nearest Yangjie's sales office for further assistance.